

brand	<b>QUELLE</b>
-------	---------------

date	JAN/03	SHEET 1/3
------	--------	-----------

Model

<b>UNIROPA</b>

Product number

<b>953875230</b>

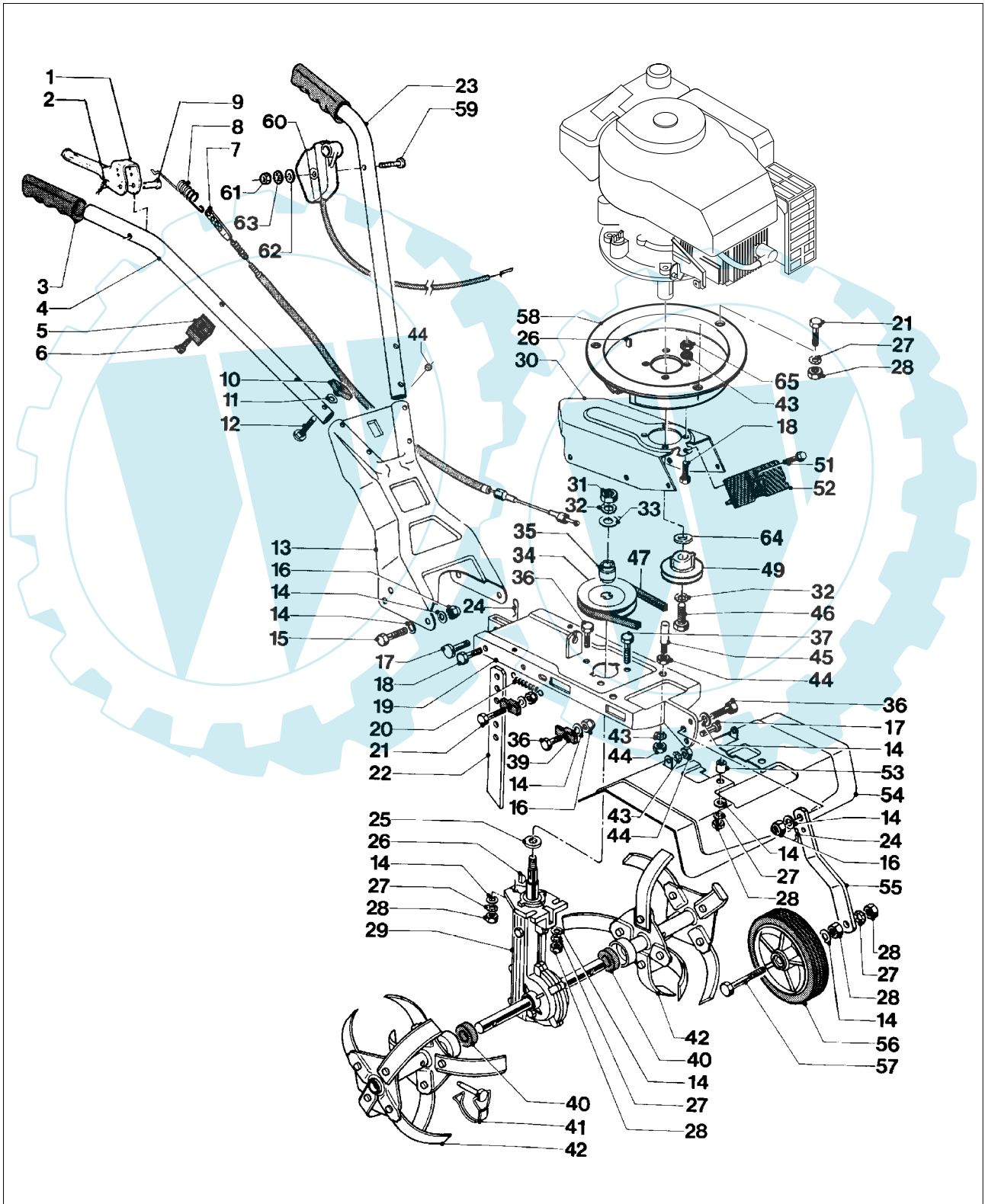

brand	<b>QUELLE</b>
-------	---------------

date	JAN/03	SHEET 2/3
------	--------	-----------

Model

<b>UNIROPA</b>

Product number

<b>953875230</b>

Pos.	PN ELX	PN MEP	DESCRIPTION	Q.ty	NOTE
1	531205422	10 1286 83	clutch lever	1	
2	531207408	10 6513 00	cotter pin	1	
3	531205267	10 1226 83	sheating	2	
4	531205262	10 1226 62	handle	1	
5	531207923	10 8761 03	cable bearing	1	
6	531207937	10 8780 00	screw	1	Ø 3.9x16
7	531205273	10 1227 30	clutch cable	1	
8	531205326	10 1233 80	spring	1	
9	531207409	10 6514 00	pin	1	
10	531204960	10 1157 03	wing nut	4	M6
11	531204961	10 1159 00	washer	4	Ø 6,5
12	531207842	10 8308 00	screw	4	M6x40
13	531205281	10 1227 72	handle bearing	1	
14	531204922	10 1142 00	washer	20	Ø 8
15	531208585	20 3823 00	screw	4	M8x2 0
16	531208599	20 4049 00	nut	9	M8
17	531205293	10 1229 90	pin	2	
18	531208769	20 6551 00	screw	6	TE M6 x 16
19	531205248	10 1226 22	deck	1	
20	531205290	10 1229 20	spring	2	
21	531205196	10 1217 00	screw	5	M8 x 35
22	531205291	10 1229 73	rod	1	
23	531205305	10 1230 82	handle	1	
24	531208657	20 5012 90	cotter pin	2	
25	531206629	10 2447 00	washer	1	14/29
26	531204907	10 1009 00	key	2	WOODRUFF 4x6,5
27	531207981	20 1062 00	washer	9	8/E
28	531207982	20 1063 00	nut	10	M8
29	531204421	09 1235 20	reducer kit	1	
30	531205254	10 1226 32	upper deck	1	
31	531207978	20 1017 00	nut	1	M10
32	531208974	30 1021 00	washer	2	Ø 10/E
33	531207989	20 1130 00	washer	1	Ø 30/10
34	531205243	10 1225 90	pulley	1	
35	531205286	10 1228 70	couping	1	
36	531208586	20 3853 00	screw	4	M8x 25
37	531204905	10 0691 00	screw	2	M8x 45
39	531205275	10 1227 53	slider	4	
40	531205297	10 1230 43	washer	2	
41	531205271	10 1227 10	pin with spring	2	
42	531205270	10 1227 03	blade star	2	
43	531208499	20 2866 06	washer	8	Ø 6/E

brand	<b>QUELLE</b>
-------	---------------

date	JAN/03	SHEET 3/3
------	--------	-----------

Model

<b>UNIROPA</b>

Product number

<b>953875230</b>

Pos.	PN ELX	PN MEP	DESCRIPTION	Q.ty	NOTE
44	<b>531207165</b>	<b>10 5012 00</b>	nut	10	M6
45	<b>531205292</b>	<b>10 1229 80</b>	pin	2	
46	<b>531208008</b>	<b>20 1205 80</b>	screw	1	Ø 3/8" UNF x 37
47	<b>531205295</b>	<b>10 1230 20</b>	belt	1	Z17 3/4 (10x450 Li)
49	<b>531205332</b>	<b>10 1235 70</b>	pulley	1	
51	<b>531207120</b>	<b>10 4274 00</b>	screw	1	Ø 4,8 x 13
52	<b>531205276</b>	<b>10 1227 63</b>	plate	1	
53	<b>531205296</b>	<b>10 1230 30</b>	spacer	2	
54	<b>531205256</b>	<b>10 1226 43</b>	deflector	1	
55	<b>531205269</b>	<b>10 1226 93</b>	rod	1	
56	<b>531204876</b>	<b>10 0239 03</b>	wheel	1	
57	<b>531207105</b>	<b>10 4076 00</b>	screw	1	M8 x 70
58	<b>531205288</b>	<b>10 1228 93</b>	motor support	1	
59	<b>531205328</b>	<b>10 1234 20</b>	screw	1	M4 x 45
60	<b>531205300</b>	<b>10 1230 70</b>	accelerator	1	
61	<b>531208490</b>	<b>20 2805 00</b>	nut	1	M4
62	<b>531207170</b>	<b>10 5012 50</b>	washer	1	Ø 4/12/1
63	<b>531207128</b>	<b>10 4801 00</b>	washer	1	Ø4E
64	<b>531207122</b>	<b>10 4289 00</b>	washer	2	Ø 10/21/2
65	<b>531208491</b>	<b>20 2818 00</b>	nut	4	M6 NYLON